



**36/725 Gowan Road Calamvale QLD**

3 2 1

Positioned in a highly convenient and well-connected pocket of Calamvale, this low-maintenance residence at 36/725 Gowan presents an outstanding opportunity for investors and future owner-occupiers alike. Set in a central location, you're just moments from local shops, schools, parks, and public transport ? making everyday life simple, practical, and stress-free.

Currently leased to a reliable tenant until the end of the year, this property offers immediate rental income from day one, along with flexibility for the future ? whether you choose to move in, continue leasing, or add value over time.

Designed with a functional and easy-care layout, the home is ideal for those seeking a hassle-free lifestyle or a

[For full version visit the website](https://www.eresidential.com.au)

**Type** : Townhouse  
**Price** : New to Market  
**Building Size** : 160 sqm  
**Land Size** : 182 sqm  
**View** : <https://www.eresidential.com.au/8687845>



**Welly Cendana**  
07 3521 5478



**Taan Suwanduang**  
07 3521 5478



**Welly Cendana** | 0414 768 599  
welly@eresidential.com.au



**Taan Suwanduang** | 0451 669 774  
Taan@eresidential.com.au

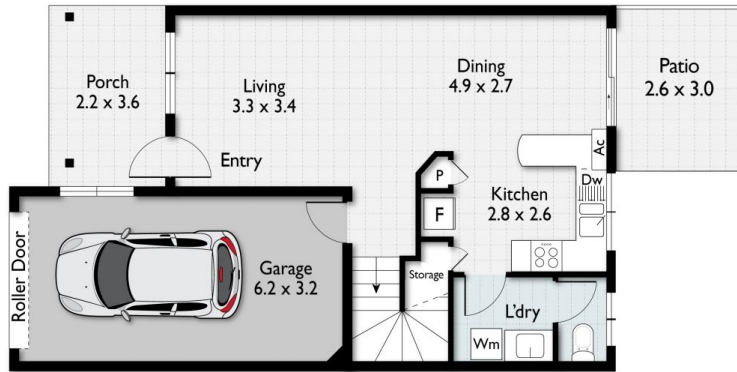

36/725 Gowan Road, Calamvale

🚗 3 🚿 2 🚻 1 🏠 160m<sup>2</sup>



Scale in meters. Indicative only. Dimensions are approximate.  
All information contained herein is gathered from sources we believe to be reliable.  
However, we cannot guarantee its accuracy and interested persons should rely on their own enquiries.