



12 Killinure Street Beenleigh QLD

3 1 6

Sold Under the Hammer - Team Robby Christanto and Welly Cendana!!

Low-Medium Density Zoning, Renovated Family Home in Prime Position With Dual Living Potential

AUCTION DETAILS

When: Saturday 7th March 2026

Where: Onsite

Time: Doors Open at 12:30PM & Auction Starts at 1:00PM

In a prime position with leafy elevated views, this beautifully renovated home has a spacious living area, garage parking under the house for four vehicles, and a separate double garage with dual living potential, all located just steps from

[For full version visit the website](https://www.eresidential.com.au)

Type : House
Price : \$ 1,050,000
Building Size : 150 sqm
Land Size : 665 sqm
View : <https://www.eresidential.com.au/8618166>



Robby Christanto
07 3521 5478



Welly Cendana
07 3521 5478



Welly Cendana | 0414 768 599
welly@eresidential.com.au



Robby Christanto | 0425 970 333
robb@eresidential.com.au

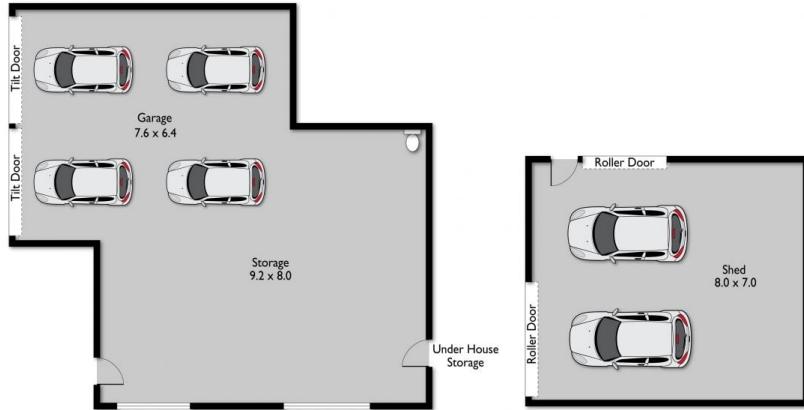

12 Killinure Street, Beenleigh

3 1.5 6 150m² 160m² 665m²



Scale in meters. Indicative only. Dimensions are approximate.
All information contained herein is gathered from sources we believe to be reliable.
However, we cannot guarantee its accuracy and interested persons should rely on their own enquiries.

