



5 Hillside Crescent Edens Landing QLD

4 2 4

This lovely home has plenty of space for the whole family with two living areas, two outdoor entertaining zones, manicured tropical gardens, and a great master suite, all in a commanding position with elevated views across the treetops to the northeast.

From the street, the home has a grand exterior with stone retaining walls, wide verandah, and beautiful gardens. Head upstairs to the full length verandah where you can relax with family and friends while you take in a gorgeous outlook across Chatfield Park.

Inside, the spacious lounge room flows into the open plan kitchen and dining area with fireplace, perfect for modern family living. Entertaining is easy as the dining area extends out onto the covered alfresco area through glass sliding doors. The private backyard offers plenty of grassed

Price : \$ 785,000
Building Size : 394 sqm
Land Size : 760 sqm
View : <https://www.eresidential.com.au/7961312>



Robby Christanto
07 3521 5478



Welly Cendana
07 3521 5478



Robby Christanto | 0425 970 333
robby@eresidential.com.au

Welly Cendana | 0414 768 599
welly@eresidential.com.au

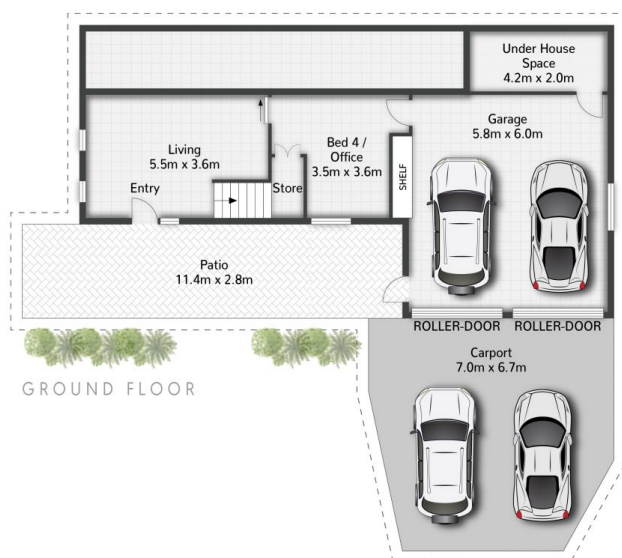

5 Hillside Crescent **EDENS LANDING**

4 Beds | 2 Bathrooms | 4 Carports | 394m² | 760m²

All dimensions are approximate; they are subject to errors and inaccuracies and no liability will be accepted.
Plans are shown for marketing purposes only.

eresidential
honesty, integrity, family.