

16/53 Injune Circuit Calamvale QLD

3 3 1

So conveniently located, this as new townhouse presents such a unique opportunity for both investor and end user alike. Located at the private edge of this modern complex, relax in the downstairs open areas or covered patio, whilst admiring the picturesque sculpted rock/plant walls. The separate upstairs study and retreat are an added bonus, with the 3 well sized ensuites affording the privacy we all desire.

Features include:

Open plan lounge/family with separate dining area
Spacious modern kitchen featuring half island stone benchtop, whirlpool dishwasher and oven, pantry and extra wide refrigerator space.

Large storage area under stairwell.

3 spacious bedrooms, all with built in robes, the master providing a shelved walk-in

3 well-sized ensuites

Price : \$ 640,000
Building Size : 130 sqm
Land Size : 166 sqm
View : <https://www.eresidential.com.au/7934169>



Welly Cendana
07 3521 5478



Peter Palmer
07 3521 5478

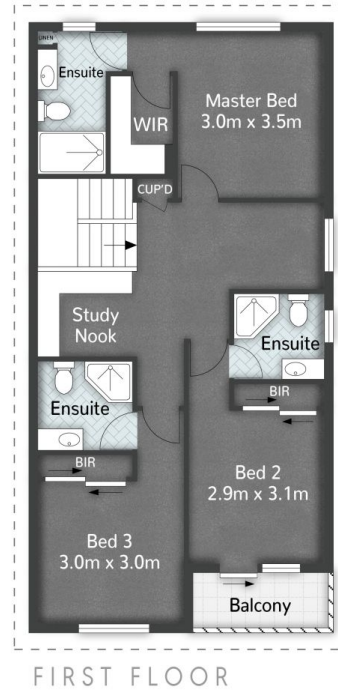
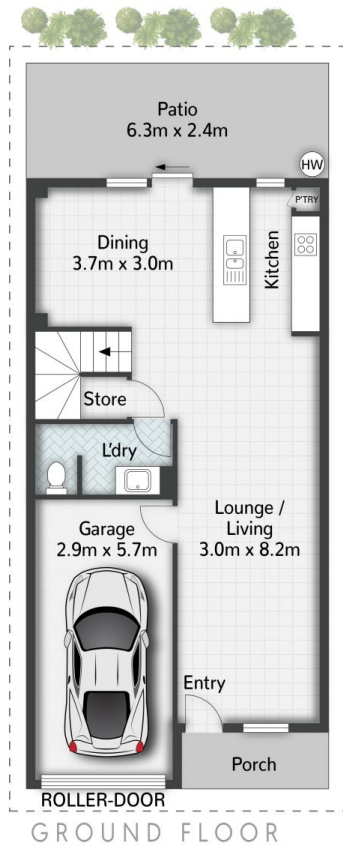

Internal 151m²
External 15m²

3 | 3 | 1 | 166m² | 90m²

16/53 Injune Circuit **CALAMVALE**

All dimensions are approximate; they are subject to errors and inaccuracies and no liability will be accepted. Plans are shown for marketing purposes only.

eresidential
honesty, integrity, family.